



Magnum Energy Inc.  
 1111 80th Street SW, Suite 250  
 Everett, WA, USA 98203  
[www.magnumenergy.com](http://www.magnumenergy.com)

This ME-RB Owner's Manual provides information on the ME-RB basic remote control and is a supplement to the ME-RC Owner's Manual (Part Number: 64-0003).



The information in this guide pertains to the ME-RB with revision 8.4 or higher; press the TECH pushbutton and view the 02 Revisions display for information on your remote's revision level.

## ME-RB Basic Remote Control

The ME-RB is Magnum Energy's basic remote control. It operates very similar to the ME-RC, but is specifically developed for OEM's to allow only the basic operations of the Magnum Energy inverter/charger to be adjusted.



**Info:** For information on installing, operating and troubleshooting the ME-RB, refer to these sections in the ME-RC Owner's Manual.



**Figure 1, ME-RB Remote Control**

### Differences between the ME-RB and ME-RC

The ME-RB remote is installed and operates identically to the ME-RC except for the following changes:

- The ME-RB does not include the AGS and METER pushbuttons. The AGS and METER pushbuttons are required to control and monitor the ME-AGS Auto Generator Start controller and ME-BMK Battery Monitor.
- The ME-RB does not include the Power Saver™ feature. The display backlighting and status LED's always remain on.
- The SETUP menu in the ME-RB only provides menu items required for basic OEM inverter/charger system configuration.

**ME-RB SETUP Menu:**



**Info:** For information on navigating the remote control, see the ME-RC Owner's Manual (PN: 64-0003).



**Info:** See figure 3, *ME-RB Menu Map* for a complete map of the menu items and adjustable settings available for the ME-RB remote control.

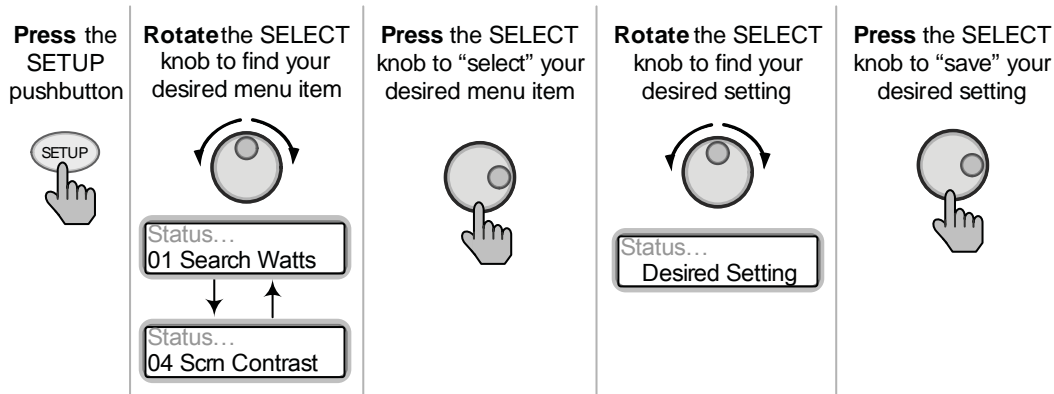

**Figure 2, Accessing the SETUP Menu Items**

- **SETUP: 01 Search Watts** - Allows you to turn off the Search Watts feature or adjust the power level to determine when the search watts feature becomes active. The power level range selection is 5W to 50W. If this feature is not needed, select *Search=Off*. When search is turned off, the inverter continuously provides full AC voltage to the loads. For more information on this setting, see the **SETUP: 01 Search Watts** section in the ME-RC Owner's Manual.

**Default setting:** *Search= 5W*

- **SETUP: 02 Batt AmpHrs** - Used to select the approximate capacity of the battery bank connected to the inverter. This setting determines the time the battery charger is in the Absorb Charging stage (i.e. Absorption Time). Selections are in 200 AmpHrs increments from 200 - 1600 AmpHrs. For more information on this setting and to correlate the battery capacity to the Absorption Time; see the **SETUP: 03 Batt AmpHrs** section in the ME-RC Owner's Manual.

**Default setting:** Batt AmpHrs= 400

- **SETUP: 03 Battery Type** - Used to select the battery type, which determines the battery charge profile and ensures the batteries are receiving the proper charge voltage. Selections are GEL (for Gel batteries), Flooded (for liquid lead acid batteries), AGM 1 (for Lifeline AGM batteries) and AGM 2 (for East Penn/Deka/Discover/Trojan AGM batteries). For more information on this setting and to determine the charging voltage; see the **SETUP: 04 Battery Type** section in the ME-RC Owner's Manual.

**Default setting:** BattType = Flooded

- **SETUP: 04 Scrn Contrast** - Used to adjust the contrast of the LCD screen for the best looking display based on the current lighting conditions and viewing angle.

**Default setting:** Contrast = 32

### ME-RB Menu Map

The following figure is a complete overview of the settings and info displays available in the ME-RB; this should help with menu navigation.

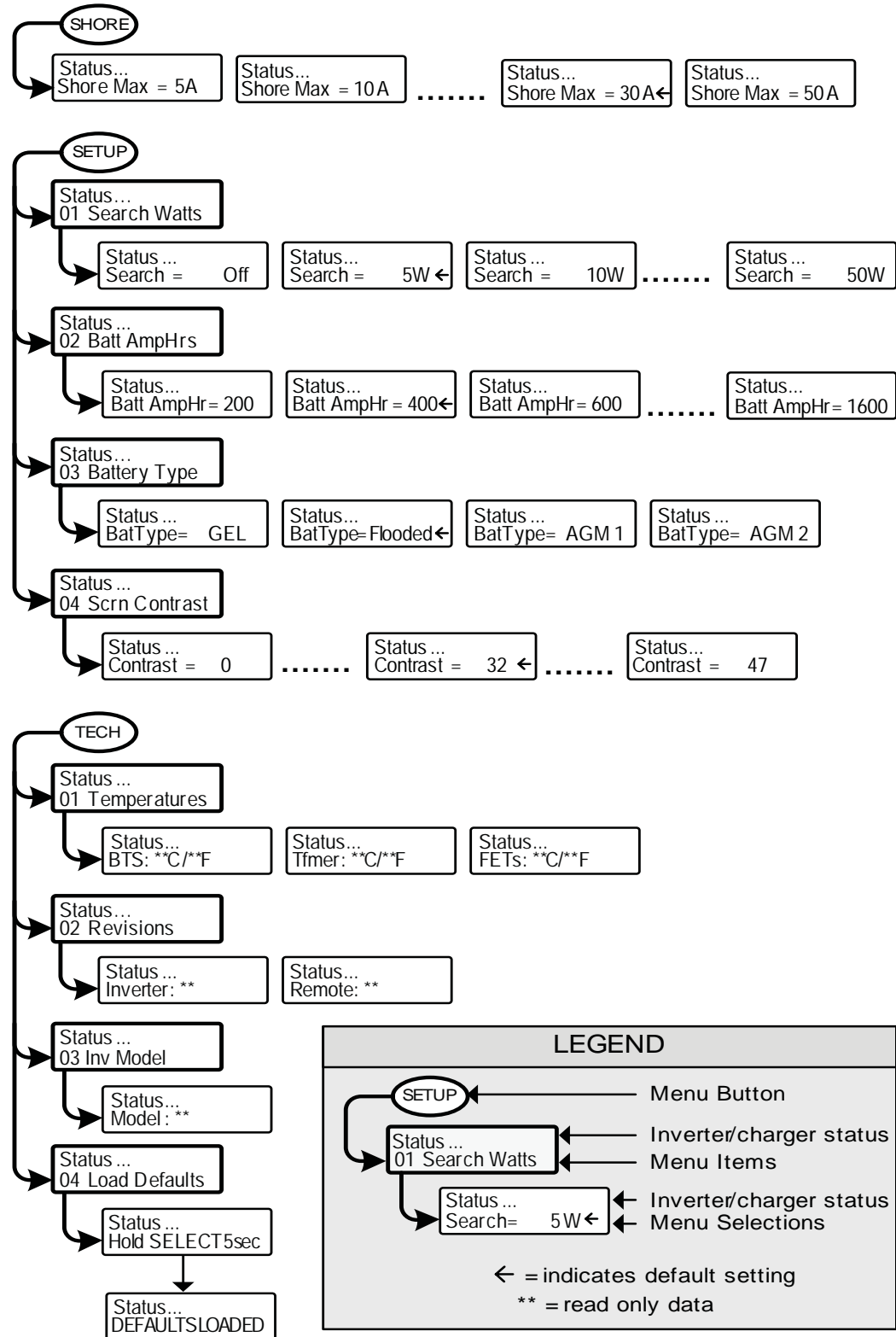

Figure 3, ME-RB Menu Map

## **Limited Warranty**

Magnum Energy, Inc., warrants the ME-RB Remote Control to be free from defects in material and workmanship that result in product failure during normal usage, according to the following terms and conditions:

1. The limited warranty for this product extends for a maximum of 24 months from the product's original date of purchase or for the same period as the connected Magnum Energy inverter if the inverter and remote are newly installed at the same time; whichever is longer.
2. The limited warranty extends to the original purchaser of the product and is not assignable or transferable to any subsequent purchaser.
3. During the limited warranty period, Magnum Energy will repair, or replace at Magnum Energy's option, any defective parts, or any parts that will not properly operate for their intended use with factory new or rebuilt replacement items if such repair or replacement is needed because of product malfunction or failure during normal usage. The limited warranty does not cover defects in appearance, cosmetic, decorative or structural parts or any non-operative parts. Magnum Energy's limit of liability under the limited warranty shall be the actual cash value of the product at the time the original purchaser returns the product for repair, determined by the price paid by the original purchaser. Magnum Energy shall not be liable for any other losses or damages.
4. Upon request from Magnum Energy, the original purchaser must prove the product's original date of purchase by a dated bill of sale, itemized receipt.
5. The original purchaser shall return the product prepaid to Magnum Energy in Everett, WA. After the completion of service under this limited warranty, Magnum Energy will return the product prepaid to the original purchaser via a Magnum-selected non-expedited surface freight within the contiguous United States and Canada; this excludes Alaska and Hawaii.
6. If Magnum repairs or replaces a product, its warranty continues for the remaining portion of the original warranty period or 90 days from the date of the return shipment to the original purchaser, whichever is greater. All replaced products and parts removed from repaired products become the property of Magnum Energy.
7. This limited warranty is voided if:
  - the product has been modified without authorization,
  - the serial number has been altered or removed,
  - the product has been damaged through abuse, neglect, accident, high voltage or corrosion.
  - the product was not installed and operated according to the owner's manual.

**BEFORE RETURNING ANY UNIT, CONTACT MAGNUM ENERGY FOR A RETURN MATERIAL AUTHORIZATION (RMA) NUMBER.**